PARK HYATT DUBAI™

LUXURY *is* PERSONAL

Park Suite



Park Suite Living Room



Park Suite Bedroom



Park Suite Bathroom



In-Room Breakfast

Park Suite

Room features:

- 109 sq. metre suite
- Interconnecting Park Deluxe King or Park Deluxe Twin room (optional)
- Separate sitting area with dramatic décor
- Dedicated work area
- Bath with separate tub and walk-in shower
- Balcony with stunning views overlooking Dubai Creek

Dedicated features:

- Complimentary breakfast
- Private minibar (refreshed once daily)
- VIP in-room amenities with wine or sparkling juice

Floor Plan Layout

Park Suite

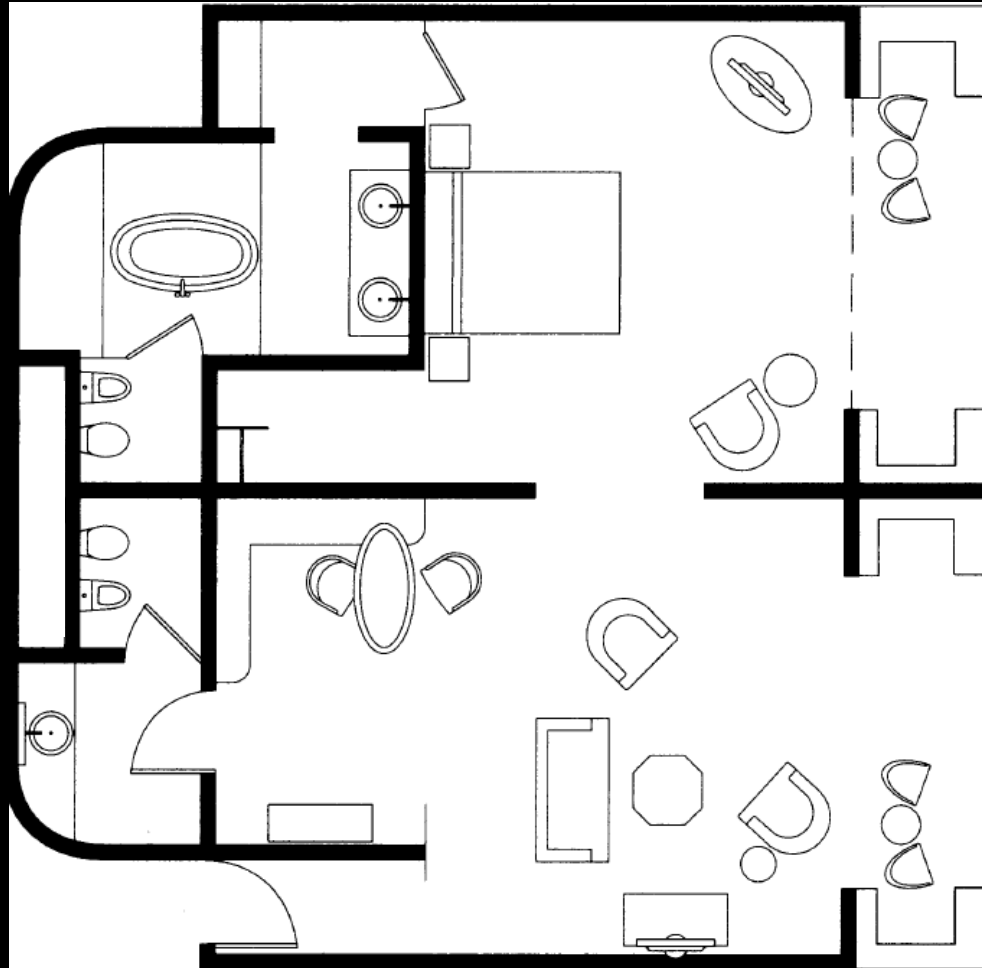

Floor Plan Layout

Park Suite interconnecting to Park Deluxe Twin Room

